

Scan QR code for more information

SMARCYCLE

Instructions Manual Model:X

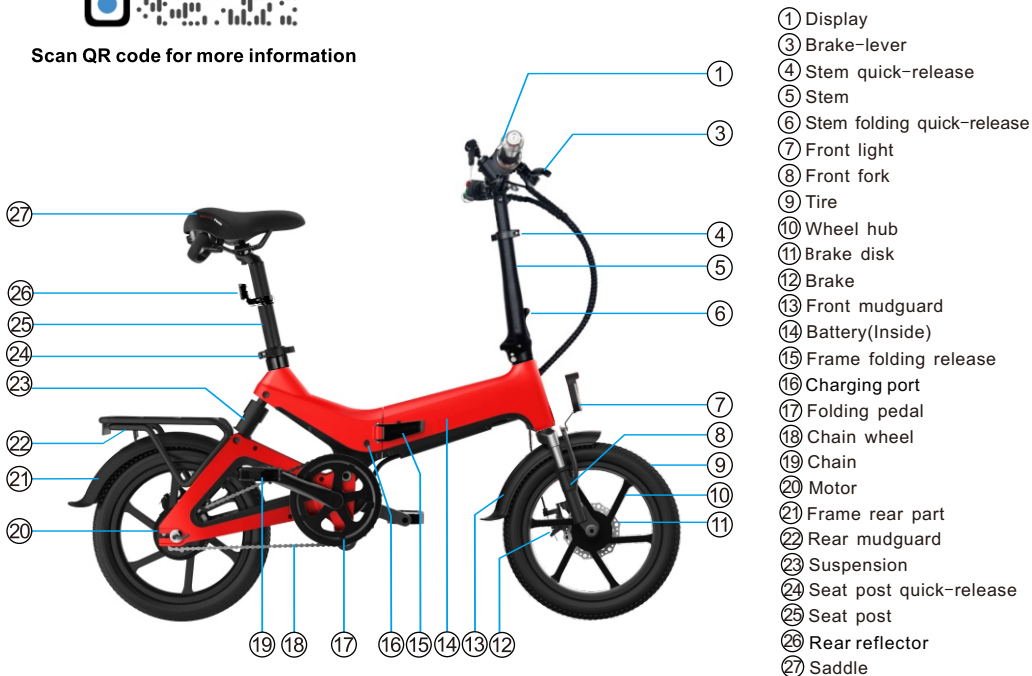

Charging

Red light on charger indicates charging

Green light indicates fully charged

Battery can be charged separately after removal

External charging port



Controls

Hold "i" to power on vehicle

"+" and "-" to change speed settings

"+" for higher power speed;press "+"for 2 seconds to turn On/Off front light



Press "i" for 2 seconds for power On/Off

"-" for lower power speed; press constantly to start assisting walking mode

PLEASE NOTE: Please do not exceed the maximum height limit when adjusting the seat post (Height dash line printed on the rear side of the seat post)

Folding

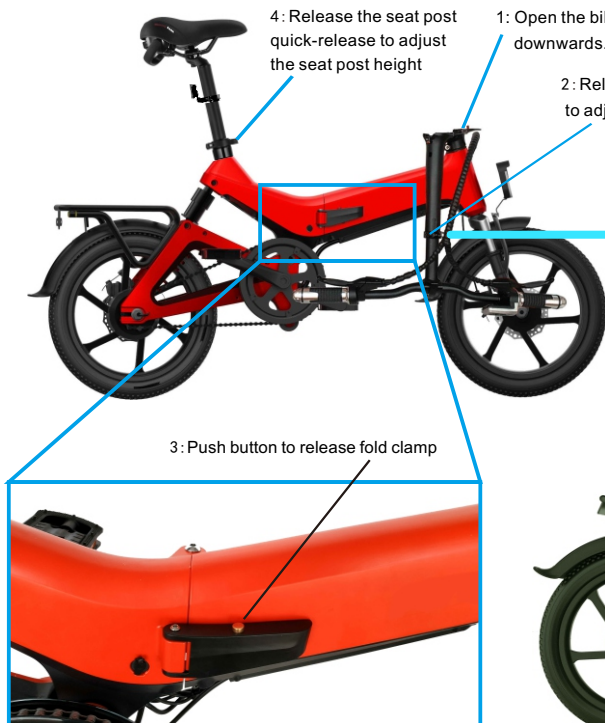

Optional Thumb Throttle Plug-in location for off-road used only (intersection of the black cable bundle), remove the lid on the socket and then plug in the throttle.



Frame folded

5: Press the pedal inward and turn upwards to fold



Battery lock socket:
turn left to release; turn right to lock



Specifications

Size

Material	Magnesium alloy
Folded size	770*430*700mm
Unfolded size	1400*610*1100mm
Pedal to ground shortest distance	100mm
Wheel size	16"
Packing size	820*380*640mm

Performance

Weight	20kg
Max load	120kg
Optimum speed	20km/h
Max speed	25km/h
Range	50km
Power consumption	1.08KW/h/100KM
Max Uphill	25 degree
Temperature	-10 ~ 45°C
Waterproof degree	IP54

Standards

Battery cells	Lithium 18650
Battery capacity	10.5 AH
Battery rate voltage	36V
Electrical start-up mode	Pedelec
Motor rated rotating speed	355r/min
Motor rated voltage	36V
Motor rated power	250W
Charging voltage	DC42V
Input voltage	Ac100 ~ 220V
Undervoltage protection value	31V
Overcurrent protection value	1.5A
Charging time	3 hours

Features

Display	Digitech Coloured LCD
Front light	Yes
Cruise	Thumb throttle – OFF ROAD USE ONLY
Brakes	Hydraulic Disc Brakes

Disclaimer: Statistical data may vary based on environment.

General Installation Notes

1. Pedals are required to install. Please note there are 'LEFT' and 'RIGHT' labels on the side of the pedals, put the pedals on the left and right side of the bike cranks respectively.
2. When install the seat post, please be aware that there is a maximum height limit measuring lines printed on the seat post. Do not exceed the maximum height when adjusting the seat height. Make sure the clamp is in a reasonable tightness to hold the seat post.
3. Left and Right brake levers are required to tighten up into a fixed position.
4. Recommended tyre pressure is 30 PSI, use hand pump is preferred.
5. Thumb throttle is included in the accessories box, you might wish to connect and use it ONLY in off-road condition. The connector is located at cable bundle inside the black strap near the top section of the front bike stem.
6. Please check the battery if it is in unlock position before you pull or remove the battery out, forcing to pull or remove the battery out in locked position might break the battery handlebar.
7. The black rubber pads on the battery case are to reduce the movement and act as an shock absorber in the battery chamber. If you cannot fold the bike smoothly, it might be due to the battery location is not correct inside the battery chamber (Either too up or too down). Try to relocate the black rubber until you can fold the bike seamlessly.
8. After riding, please place the bike where is free from sunlight and rain.
9. Please do not ride the bike in extreme weather or heavy rain condition.

If you have any further questions, please visit our website and feel free contact us.
www.smarcycle.com.au

CAUTION

Charging:

Recommended ambient temperature while charging is -10 to 45 degrees celsius. Keep battery and charger away from water and heat sources. Do not disassemble or modify battery and charger units. When full charge is reached, promptly disconnect charger. Do not charge with amperage over 2A.

If you're putting the vehicle into long term storage, store the battery in a cool and dry environment. It is optimal for battery life if the battery is charged from flat to full every two months.

A solid red light indicates normal charging. A red flashing light on the charging unit indicates charging fault.

If this is observed please cease charging and contact us or a licensed electrician for support.

Please do the same if charger or battery overheats.

Operation:

Please thoroughly read the instruction manual prior to riding in order to familiarise yourself with the functions and specifications of your vehicle. Do not allow unfamiliarised riders to operate vehicle.

Suitable rider age range: 16 to 65 years
Always wear protective equipment when riding.
Always obey local traffic laws when riding.

Recommended operating temperature is between -20 to 50 degrees celsius. The rider is responsible to ensure riding is performed within the recommended temperature range.

Please check brakes prior to riding

Be mindful that the vehicle's braking distance will increase in wet or icy environments, if the brake pads and discs are worn and or if the tread on the tires are low.

Speed should be kept at or below ~15km/h when riding down steep hills or on slippery surfaces.

Inspect tyre pressure prior to riding. Pressure should be kept at 30 - 35PSI.

Do not overload vehicle. Maximum recommended weight is 120Kg.

Do not ride with one hand on handlebar.

Do not raise seat past maximum point marked on the seat shaft.

Make sure all joints, clasps and any tensioning device on the vehicle is secure before use.

This vehicle is not designed for, nor intended to be use for stunts, offroading or extreme riding activities.

Maintenance:

Lubricate active components prior to use or once monthly. Use only wet lubricants recommended by Volt.

Store vehicle in a cool and dry environment after use.

Check tyre pressure, motor and brakes often. Do not lubricate brake discs/pads.

Keep away from children and pets.

Warranty:

For warranty information please scan the QR code to visit our website for detailed information.

Product warranty will only cover use within the recommended parameters, outlined above and online.

Product disclaimer:

All material included with the 'SMARCYCLE X' packaging is subjected to intellectual property protection, inclusive of all product design, technology and marketing language ('The Product', 'Copyrighted material'). Copyrighted material may not be reproduced without written permission from SMARCYCLE. It is the responsibility of the owner and any rider of SMARCYCLE Branded products to abide by SMARCYCLE's recommendations regarding proper use of all Volt products that can be found at www.smarcycle.com.au. By using The Product, the Rider agrees to take responsibility for any personal, public and other liabilities caused by use of The Product.

For more legal information please contact us at: sales@smarcycle.com.au

■ Product Description and Specifications

● Parts Description

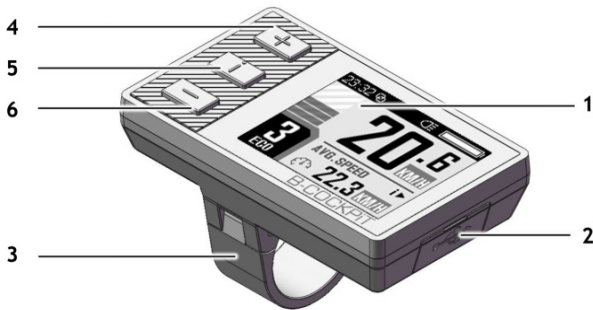

- 1. 1.77" 160x128 color TFT display
- 2. USB Port with protective cap
- 3. Mounting Bracket
- 4. "+" Button
- 5. "i" Display function button
- 6. "-" Button

● Technical Data

Rated operating voltage	24V / 36V / 48 V DC
USB port output	5V, 500mA
Operating temperature	-10°C ~ +45°C
Storage temperature	-20°C ~ +60°C

■ Installation

● Install the BC-18 Unit

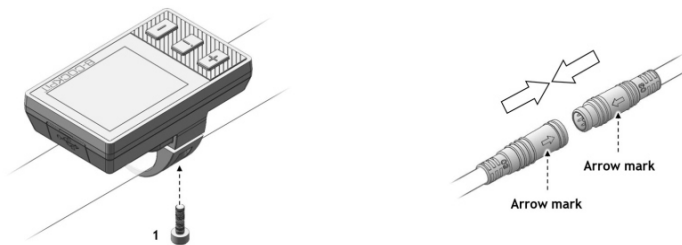

- 1. Use M3 Hex Socket Screw **1** to secure the mounting bracket to the left side of the handle bar. **Tightening torque: 0.2N.m.** Do Not Overtighten or it may cause damage to the HMI
- 2. Securely connect the cables of B-COCKPiT with E-bike controller by aligning the 2 **arrow marks**.

● Meter Interface

Meter Interface is the default interface of B-COCKPIT.

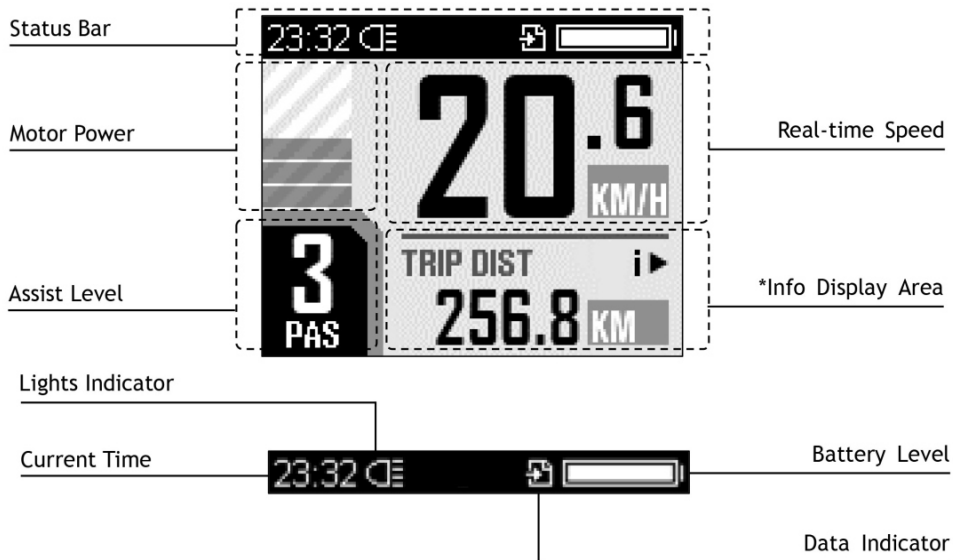

● Button Functions

1. + “+” button:

	Short Press	Long Press	Long Press & Hold
Meter Interface	Assist level Up	E-bike Lights On/Off	----
Menu Interface	Cursor Up / Increase	----	----

2. - “-” button:

	Short Press	Long Press	Long Press & Hold
Meter Interface	Assist level Down	----	6km/h Start-up Mode
Menu Interface	Cursor Down / Decrease	Cancel and Go Back	----

3. i “i” button:

	Short Press	Long Press	Long Press & Hold
Meter Interface	Change Info Display	System On/Off	----
Menu Interface	Ok / Confirm	----	----

4. + & - Press “+” and “-” buttons together:

	Short Press	Long Press	Long Press & Hold
Meter Interface	----	Enter Menu Interface	----
Menu Interface	----	Save Changes and Exit	----

Info Display Area

In Meter Interface, short press “i” to cycle through various riding and e-bike information

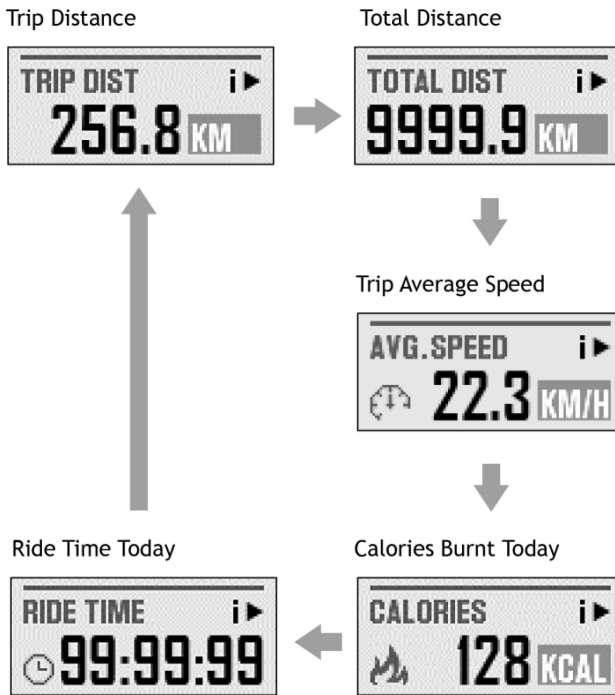

* Ride time will pause if the e-bike is not moving, and will reset at 00:00 every day.

* Calories and Ride Time will reset at 00:00 every day.

CAUTIONS REGARDING SYSTEM CONFIG

Changing the parameters in “System Config” without proper knowledge may cause abnormal behaviors of the E-bike.

And may even lead to unsafe situations.

Consult with the manufacturer first before making any changes on your own.

■ System Operations

● Initial Operations

Set System Time

1. Press and hold “+” and “-” together for 2 seconds to enter the system menu.
2. Use “+” / “-” to navigate to the “Display Setting” line and press “i”.
3. Select “Set Date & Time” and following items using the same method.

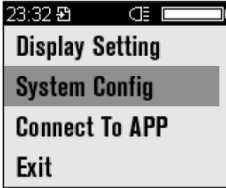

4. In each page, use “+” / “-” to adjust the parameters,
5. The parameters being adjusted are shown as flashing numbers.
6. When finished, press “i” to proceed to the next parameter until all parameters are set.



■ Miscellaneous Interfaces

● Error-Code Notification



Error-Code Table (example only, customer dependent)

Error-Code	Description	Corrective Measure
21	Controller Protection	Check if 3-phase power lines are properly connected
22	Throttle Error	Check throttle connection, replace motor if necessary
23	Motor Phase Error	Check motor connection, replace motor if necessary
24	Speed Sensor Error	Check sensor connection, replace sensor if necessary
25	Brake Error	Check Brake connection, replace brakes if necessary
30	Communication Error	Check connectors and contacts between each components